



# anderson electronics, llc

A Lokos Electronics Company



721 Scotch Valley Road  
Hollidaysburg, PA 16648



Phone: (814) 695-4428  
Fax: (814) 696-0403  
E-mail: sales@aextal.com

## AE RT or RTV 119 Series Temperature Compensated or Voltage Controlled Crystal Oscillator

**AE RTX/RTV-119 Series has a Frequency Range of 9.60 MHz to 32.00 MHz**

Part Numbering Definition Guide: RTX-02-5-2070-3R3-16M384000

Product Example	RTX	02	5	2070	3R3	16M384000
Package	RTX					TCXO
	RTV					TVTCXO
Output Wave Form		02				Clipped Sinewave
Frequency Stability (Over Temperature Range)			1			+1.0 ppm
			2			+2.5 ppm
			3			+3.0 ppm
			5			+5.0 ppm
Operating Temperature				4085		-40 to +85°C
				3075		-30 to +75°C
				2070		-20 to +70°C
				1060		-10 to +60°C
Supply Voltage (±5%)					3R3	+3.3 V
					5R0	+5.0 V
Frequency Stability vs. Supply Voltage	±0.2 ppm at ±5% Vcc					
Input Current	2.0 mA maximum (9.600 MHz - 19.999 MHz) 3.0 mA maximum (20.00 MHz - 32.000 MHz)					
Load	10K Ohms//10pf					
Level	0.8V P-P for +3.0 Vdc ±5% 1.0V P-P for +5.0 Vdc ±5%					
Aging	±1.0ppm per year maximum					
Frequency Adjustment	±3.0 ppm minimum by Internal Trimmer					
Frequency Deviation RTV(TVTCXO-Only)	±4.5 ppm to ±7.5 ppm at +1.5V ±1.0 Vdc					
	±8.0 ppm to ±15.0 ppm at +2.5V ±2.0 Vdc					

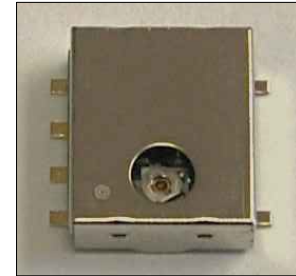

### FEATURES:

Ultra Miniature Package, Specially manufactured to insure tight tolerances for frequency stability and long term aging.

Industry standard footprint layout

Operable Temperature Range - -40°C to +85°C

Storage Temperature Range: -55°C to +125°C

ROHS Compliant/Pb-Free

### APPLICATIONS:

The 6 pin AE RTX/RTV Series surface mount package can be used for test and measurement equipment.

Wireless Communications

Broadband Access

### REFLOW SOLDERING PROFILE

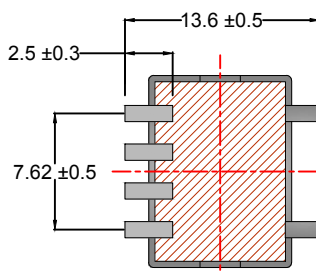
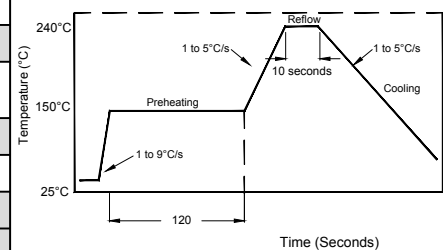

Bottom View:

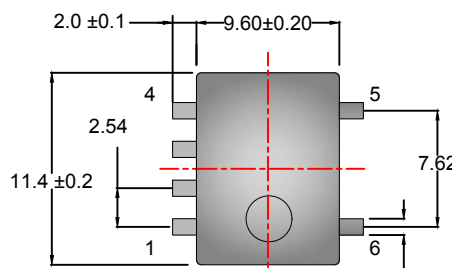

Top View:

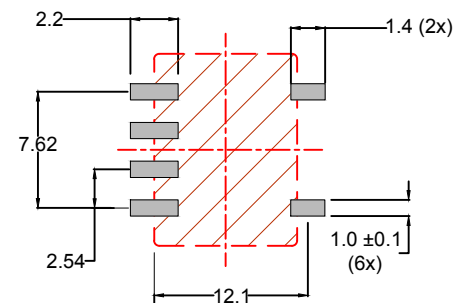

Recommended Land Pattern

Pin	Function
1	Vcc
2	N/C or V/C
3	Ground
4	Output
5	Ground
6	Ground

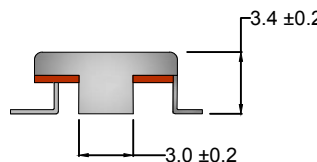

Dimensions in Units: mm